

DIN 444 Type B And C Eyebolts

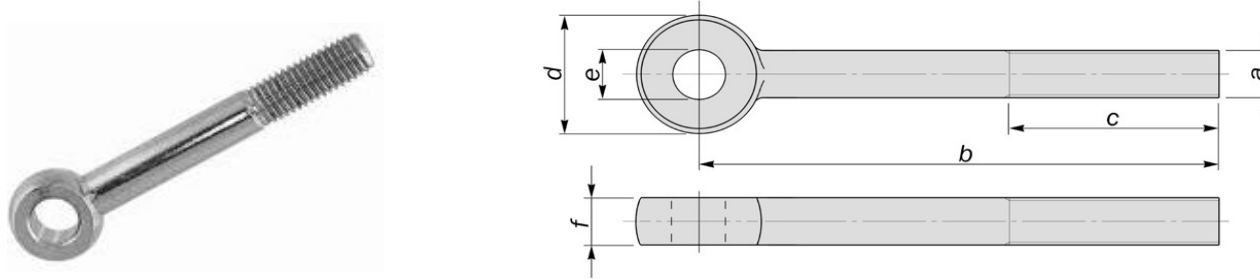

DIN 444 Type B And C Eyebolts													
Diameter	M6	M8	M8	M10	M10	M12	M12	M12	M16	M16	M16	M20	M20
b-Min.	35	40	126	45	126	55	126	201	70	126	201	100	126
b-Max.	90	125	140	125	150	125	200	260	125	200	260	125	200
C	18	22	28	26	32	30	36	49	38	44	57	46	52
d-Min.	13.57	17.57	17.57	19.48	19.48	24.48	24.48	24.48	31.38	31.38	31.38	39.38	39.38
d-Max.	14	18	18	20	20	25	25	25	32	32	32	40	40
E	6	8	8	10	10	12	12	12	16	16	16	18	18
f-Min.	6.85	8.85	8.85	11.82	11.82	13.82	13.82	13.82	16.82	16.82	16.82	21.79	21.79
f-Max.	7	9	9	12	12	14	14	14	17	17	17	22	22

Diameter	M20	M24	M24	M24	M30	M30	M36	M36	M39	M39			
b-Min.	201	100	126	201	150	201	160	201	160	201			
b-Max.	260	125	200	260	200	300	200	300	200	300			
C	65	54	60	73	72	85	84	97	90	103			
d-Min.	39.38	44.38	44.38	44.38	54.26	54.26	64.26	64.26	69.26	69.26			
d-Max.	40	45	45	45	55	55	65	65	70	70			
E	18	22	22	22	28	28	32	32	35	35			
f-Min.	21.79	24.79	24.79	24.79	29.79	29.79	37.75	37.75	40.75	40.75			
f-Max.	22	25	25	25	30	30	38	38	41	41			

Materials	Finishes
Carbon Steel	Self Colour - Electroplated
Stainless Steel	Galvanised
Alloy Steels	Sherardised
B7-4.6-5.6-8.8	PTFE Coating